

innoGIO

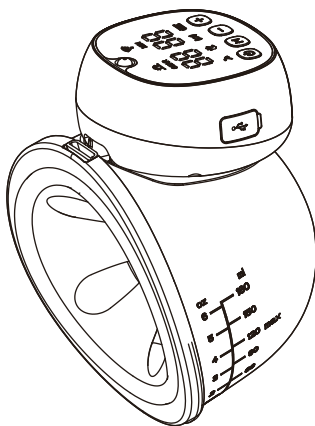

GIÖmum Line Comfort
Wearable electric breast pump

INSTRUCTION MANUAL

Congratulations on being a mother! If this is your first experience with a breast pump, it may take you some time before you get used to the way it operates.

It is important that you stay relaxed during the process, even if at the beginning you are not able to express as much milk as you would like to. Your body will adapt accordingly and after several attempts you will be able to express more milk.

PLEASE READ BEFORE USE

- Limit the usage to maximum 15 minutes at a time. It is perfectly normal when at first not much milk is expressed within this time. If you use it regularly, your body will eventually adapt to produce more milk.
- Research has shown that to achieve optimum breast milk production, you should fully relaxed. It helps you release oxytocin, a hormone that stimulates your let-down reflex for milk ejection. So, sit back on your favourite couch while listening to your favourite tunes, try breathing exercises or get your partner to give you a massage!
- The device comes with a massage function that you can use (1-3 min) before pumping. This will help your body release oxytocin and increase milk production.
- Clean the device regularly. Clean any pump parts that have been in contact with your breast milk and wash your hands before and after each use.
- Choose the right optimum suction level. Gradually increase the breast pump suction until it becomes slightly uncomfortable, and then turn it down a notch. The pump will start operating at the most recently used suction level when restarted.
- Since this is a wearable breast pump, make sure that you are using a proper nursing bra.

PRODUCT DESCRIPTION

Type-C cable - 2 pcs



Bra adjustment buckle - 2 pcs

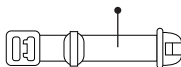

Pump motor - 2 pcs

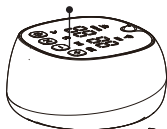

Silicone massage petal 24 mm - 2 pcs.

Silicone gas cup - 2 pcs.

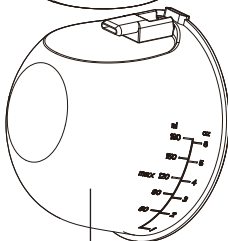

Milk collector - 2 pcs.

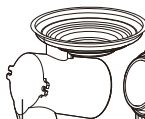

Linker - 2 pcs

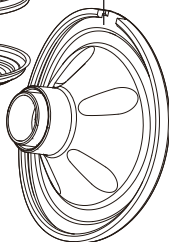

Valve - 4 pcs.

Accessories include:

Remote control - 1 pcs.

Storage bag - 1 pcs.

CONROL PANEL

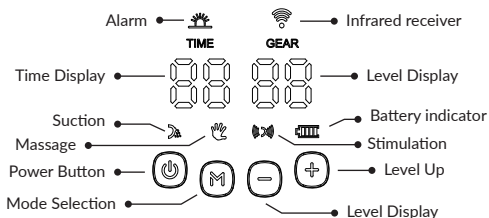

Use the massage function prior to deep pumping.

3 Modes

Massage function: 12 levels

(Massage first to stimulate milk production.)

Suction function: 12 levels

(Choose the optimum level; the pumping mode is designed for both slow and deep suction.)

Stimulation: 6 levels

(Massage and suction used simultaneously is excellent for sunken nipples or first-time mothers, open milk adopts 3+1 mode, 3 short-frequency massages and 1 deep suction.)

Turn on/off: Press and hold the power button (⏻) " for 3 seconds.

Mode Change: Press the mode key (M) ".

Level change: Press the "+" " and "-" " to increase or decrease level.

Battery and Charging Indicator

Flashing White: Low battery (charging required)

Continuous White: Battery is fully charged
(flashing white while charging)

Milk Warning: The alarm will flash red every 10 mins.

When it is time to take out the milk collector, the pump will automatically turn off every 30 mins.

CLEANING INSTRUCTIONS

Before Use

1. Remove the pump motor.
2. Place all the silicone parts in boiling water for 3 to 5 minutes.
3. Wash the milk collector and linker with warm soapy water and rinse well.
4. Wipe down the parts with a cloth or air dry before use.

After Use

1. Rinse the milk collector, valve and linker immediately after use.
2. Place all silicone parts in boiling water for 3 to 5 minutes.
3. Wipe down the parts with a cloth or air dry before storage.
4. Do not submerge the electrical part of the device in water

ASSEMBLING THE DEVICE

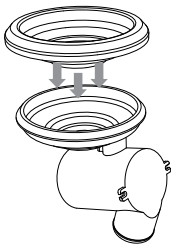

STEP 1

Put the silicone gas cup into the linker and press it with your hands to make sure the edges fasten tightly to ensure a perfect seal.

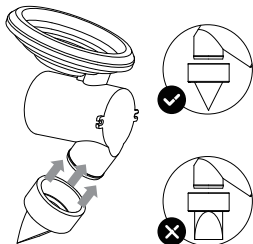

STEP 2

Install the valve into the bottom of the linker, make sure it is installed in the correct direction.

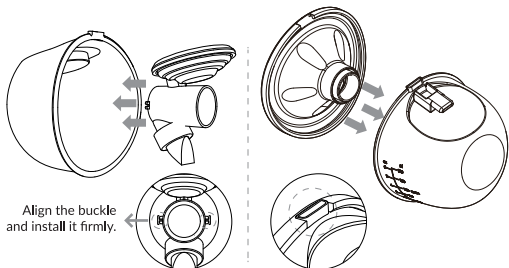

STEP 3

Pull the assembled linker into the milk collector.

STEP 4

Place the silicone massage petal into the milk collector and ensure it is sealed properly to prevent leakages.

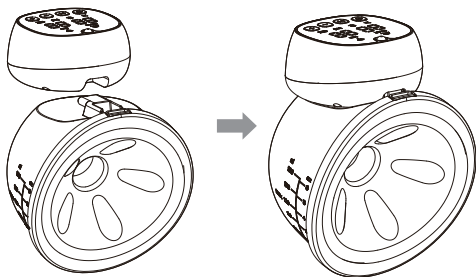

STEP 5

Install the main pump.

DIRECTION FOR USE

Placing the pump in the bra

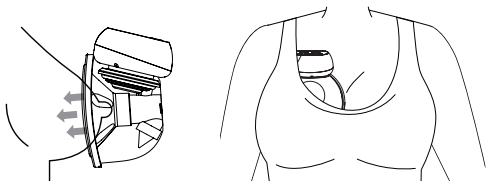

Press the silicone massage petal firmly against the breast, leave no gaps and make sure your nipples are centred. Keep the device upright. Be careful not to distort the position of the product and your chest, otherwise the breast pump will not have the necessary suction.

Turn off the pump and remove it carefully

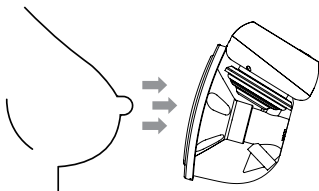

Note: Do not lie down while using the breast pump. If you feel any discomfort while expressing or notice blisters/chafing on your nipple or breast, try reducing the breast pump suction level.

SITTING POSITON FOR SUCTION

Relax your body, sit in a comfortable chair and lean slightly forward (use a cushion to support your back). Make sure to keep the breast pump and milk collector upright.

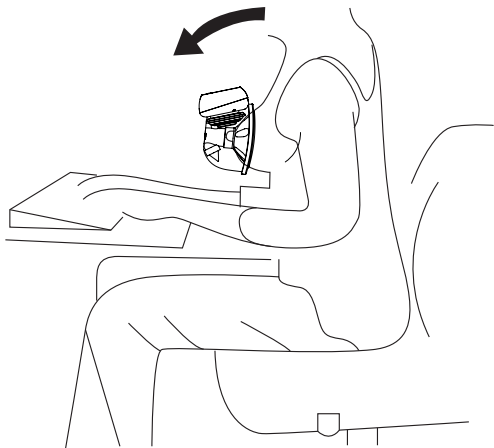

POUR MILK

Keep the breast pump upright and carefully remove the pump motor from the pump body. When pouring milk into the bottle, mind the milk collector gap.

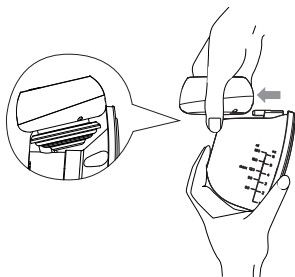

PICTURE 1

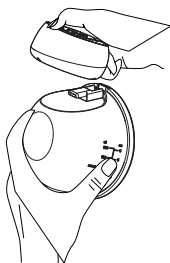

PICTURE 2

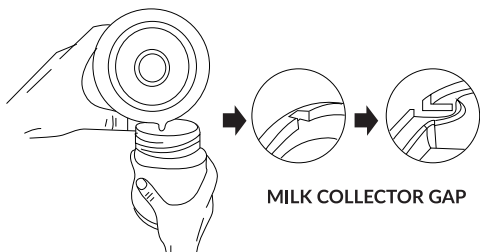

PICTURE 3

INSTRUCTIONS FOR BRA ADJUSTING BUCKLE

Adjust the length of your bra straps in order to make suction more comfortable. Hang one end of the bra adjustment buckle on the inside buckle of the nursing bra. The length of the bra can be adjusted by hanging the nursing bra buckle on the other end of the bra adjustment buckle.

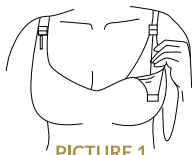

PICTURE 1

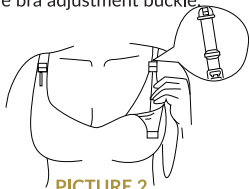

PICTURE 2

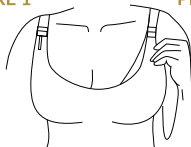

PICTURE 3

TROUBLESHOOTING

Weak suction or no suction	<ol style="list-style-type: none">1. Check whether the valve is properly installed.2. Charge the device before use.3. Check whether the device is placed correctly, otherwise the breast pump will not have suction.
Nipple pain	<ol style="list-style-type: none">1. Massage first and select a comfortable suction level.2. Consult a lactation consultant or breastfeeding.
No / little milk expressed	<ol style="list-style-type: none">1. Make sure you are in a comfortable position.2. If you have been pumping for 5-10 minutes, take a break and try again at a different time.3. Ensure an optimal suction level during use.4. Relax and try again.

REMOTE CONTROL INSTRUCTIONS

Make sure the breast pump is placed correctly inside the nursing bra and well-connected to your breast. Aim for the receiver to be above the host and press the ON/OFF button on the remote to start the pump; switch the mode freely in line with the icon on the remote control to increase or decrease the working levels. After use, press the ON/OFF button on the remote to turn the device off.

Remarks:

The remote is an additional control tool. If its is damaged or lost, the breast pump can still be operated using the buttons on the breast pump motor.

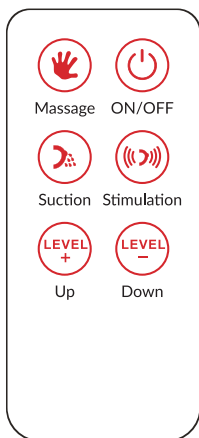

Thank you for choosing InnoGIO products!

In order to use the product well,
please read the user manual carefully
and keep it in case
you have any questions in the future.

The pictures used in the manual are for reference only.
If there are any discrepancies between the pictures
and the product please adhere
to the actual product instead.

innoGIO

Importer: **INNOGIO** sp. z o.o.
Ostródzka street 74H
03-289 Warsaw, Poland
www.innogio.com

 @innoGIO.official  @innogio_com

