

GIO-360 EN

# innoGIO

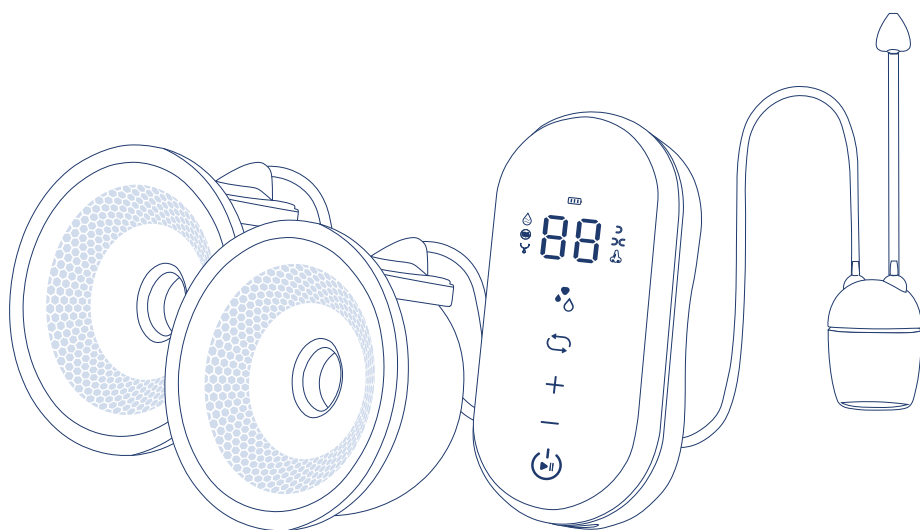

## GIOmum Line Soft

Double electric breast pump  
with nasal aspirator

INSTRUCTION MANUAL

**PLEASE READ THE INSTRUCTIONS CAREFULLY BEFORE USING THE PRODUCT AND KEEP THE MANUAL FOR FUTURE REFERENCE.**

## **INTRODUCTION**

The best thing for your baby's health is being fed with breast milk every day. But sometimes if it is inconvenient for the mother to feed the baby directly, you can use **Double electric breast pump with nasal aspirator GLOmum Line Soft GIO-360**.

GLOmum Line Soft – double electric breast pump with nasal aspirator imitates baby's sucking, it stimulates breast milk to secrete more, soothes breast pain (caused by breast engorgement). Pump milk to freeze it for later and feed your baby exclusively with breast milk when the mum is away. It supports the nasal aspirator feature for periods when the baby is sick.

## **FEATURES**

- The Double pump increases efficiency and reduces pumping time.
- Hands-free funnel fits the bra and there is no need to hold it when pumping.
- Single or double suction. Intuitive, easy-to-use symbols.
- 2 in 1: Breast pump with a nasal aspirator function, full of features, easy to assemble and clean.
- Soft silicone nasal aspirator, comfortable for baby.
- LED controls with touch buttons.
- Strong & smooth pumping with 3 suction modes: Massage mode/ Stimulation mode/ Expression mode (9 levels).
- Large rechargeable battery capacity of up to 2200 mAh allowing for long usage.
- Anti-backflow device with one-way valve.
- Rechargeable battery.

## **3 SUCTION MODES**

### **• Massage Mode:**

All levels of the massage mode work at a regular and moderate rhythm with medium suction to stimulate milk production effectively. In the massage mode, the pump offers 9 levels; on higher levels, the suction power will increase accordingly, and the suction will become more relaxed and vigorous, additionally the suction time will increase. Pressing the power button will increase the suction intensity.

### **• Expression Mode:**

All levels of the expression mode work at a regular and moderate rhythm with strong suction to express milk effectively. In the expression mode, the pump offers 9 levels; on higher levels, the suction power will increase accordingly, and the suction will become more relaxed and vigorous, additionally the suction will increase.

### ● Stimulation Mode:

In the stimulation mode, the pump offers 9 levels. At each level, it adopts a rhythm of three light suction in a row followed by one heavy stimulation, which means three massages and one expression. This rhythm helps to stimulate the release of milk.

## MODULE

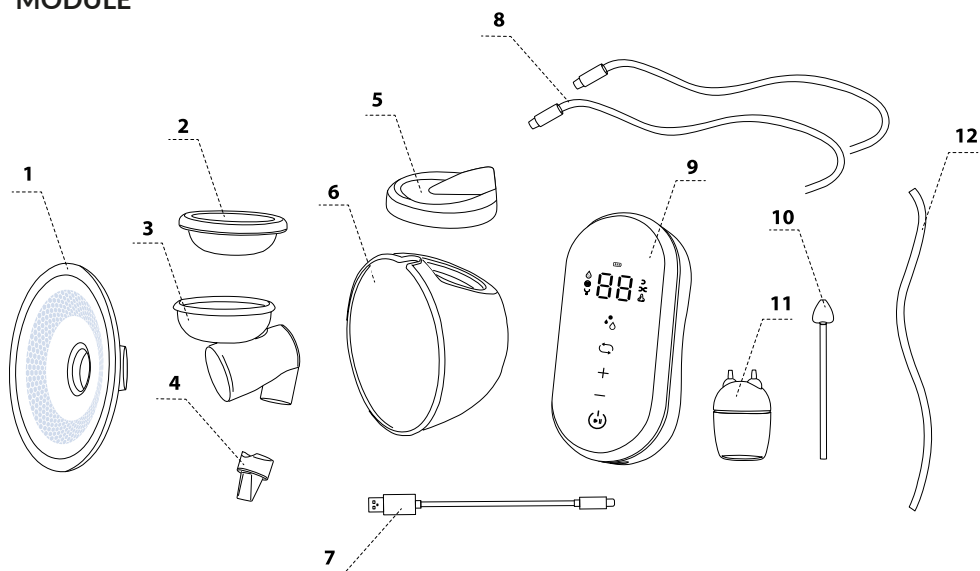

No.	Name	Quant.	Materials	Heat resistance
1	Breast shields 24 mm	2	Silicone	~ 180°C
2	Silicone Suctions	2	Silicone	~ 180°C
3	Linkers	2	Polypropylene (PP)	~ 120°C
4	Suction Valves	2	Silicone	~ 180°C
5	Upper Covers	2	Polypropylene (PP)	~ 120°C
6	Milk collectors	2	Polypropylene (PP)	~ 120°C
7	USB cable	1	xx	xx
8	Air tubes	2	Polyvinyl Chlorua (PVC)	~ 120°C
9	Motor	1	xx	xx
10	Nose suction tube	1	Silicone	~ 180°C
11	Nose fluid cup	1	Polypropylene (PP)	~ 120°C
12	Nose air tube	1	Polyvinyl Chlorua (PVC)	~ 120°C

## LED SCREEN

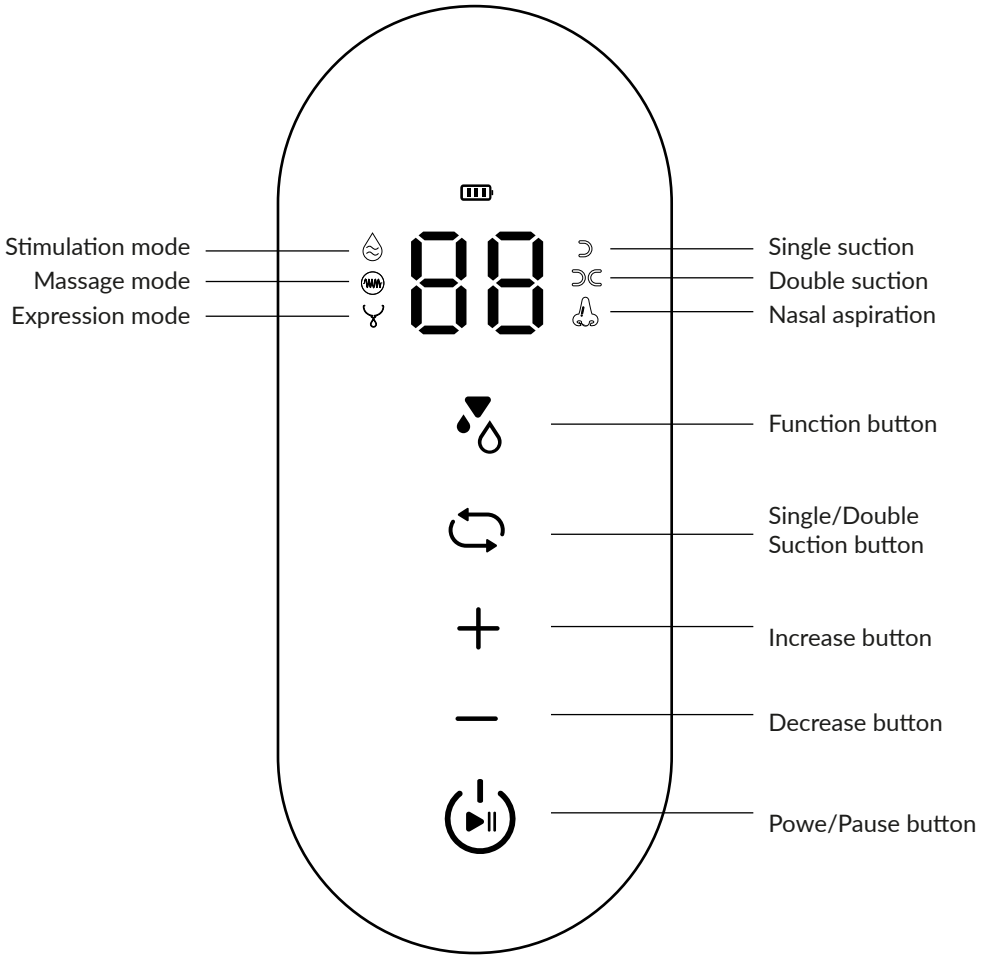

## SPECIFICATION

- Power sources: 100-240V ~ 50/60Hz with AC adapter DC 5V - 1A (not included)
- Power: 5W; Battery capacity: 2200 mAh
- Vacuum max.: 315 mmHg  $\pm$  7.5 mmHg
- Overall noise: 0,63 kg
- Storage temperature: 5° to 40°C
- Storage humidity: 10% - 90% RH
- Atmospheric pressure: 850 Hpa - 1060 Hpa



## ASSEMBLING STEPS

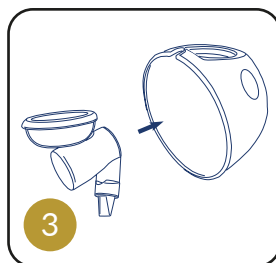

**Step 1** Put the silicone suction (2) onto the linker (3). Press around the edges of the suction silicone to cover the linker completely.

**Step 2** Push the suction valve (4) securely onto the bar of the linker (3).

**Step 3** Place the linker (3) into the internal slot of milk collector (6). Push the linker and make it get stuck in the slot.

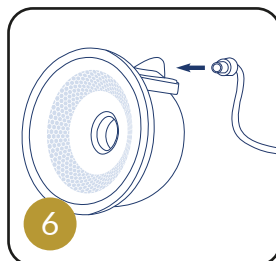
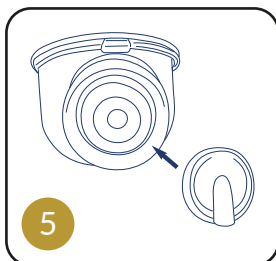
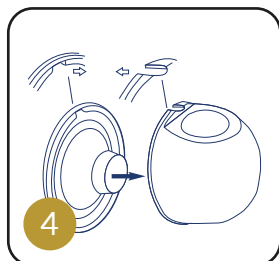

**Step 4** Put the breast shield (1) to the milk collector (6). Align the spout of breast shield and the collector.

**Step 5** Put the upper covers (5) to the milk collector (6).

**Step 6** Connect one end of the first air tube (8) to the upper cover (5) for the first milk collector.

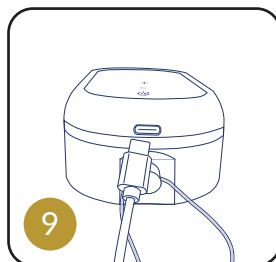
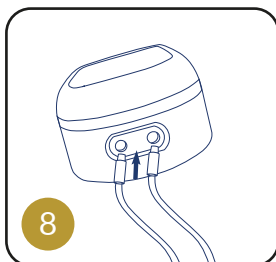
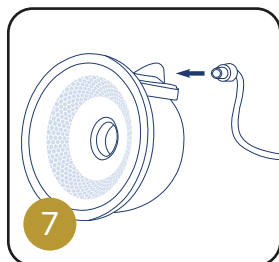

**Step 7** Connect one end of the second air tube (8) to the upper cover (5) for the second milk collector.

**Step 8** Connect the other 2 ends of both air tubes (8) to the 2 air holes of the motor (9).

**Step 9** Use the USB cable (7) to charge the motor (9) before or after each use.

## ASSEMBLING STEPS

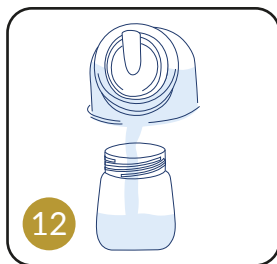
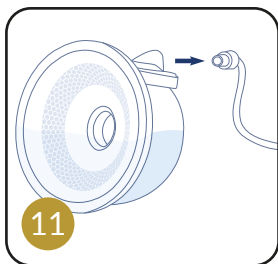
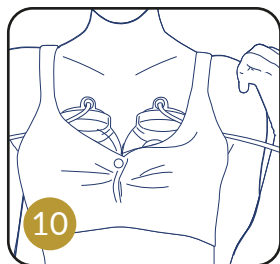

**Step 10** Place 2 breast shields inside the bra. Make sure the breast shield is pressed against the mother's chest and the air tube is not blocked.

**Step 11** After pumping, take out the air tubes (8).

**Step 12** Pour the breast milk inside the milk collector (6) into a storage bottle.

### Notes:

- For single suction  , please connect to the left air hole. This is the default position for single suction, the right air hole cannot be used for suction.
- The specific suction symbols are indicated next to corresponding air holes.

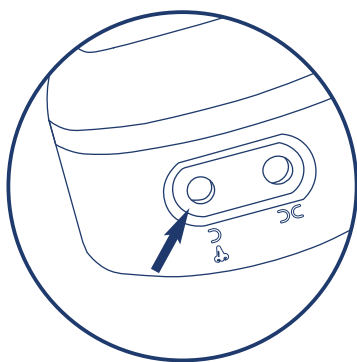

## CHECKING SUCTION & SOLUTIONS

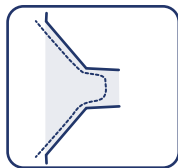

Make sure the breast shield covers your breast tightly.

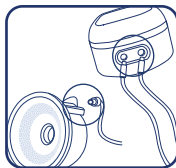

Make sure the air tube connectors are attached tightly.



Check if the silicone suction cup (2) is fitting tightly with the connector (3).



Check if the suction valve (4) is fitted and properly positioned on the rim of the connector (3).

## IMPORTANT

Follow the instructions below to avoid leakage.

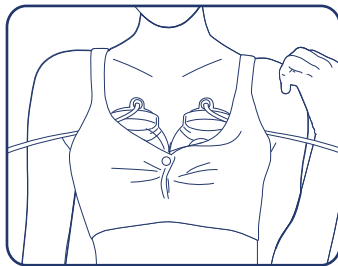
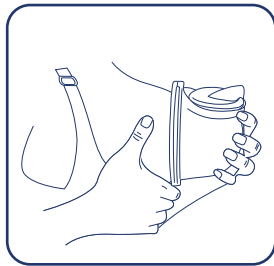
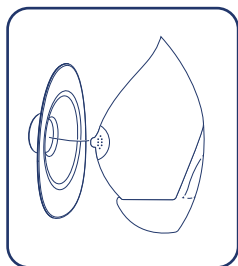

Correct nipple alignment in the Breast Shield is the key for ensuring comfort, expression, and performance. To avoid discomfort, the nipple must be positioned correctly in the breast shield tunnel before pumping.

## Follow posture instructions

The best breastfeeding position is to sit upright and lean forward slightly. When sitting and standing, leaning forward can help in easy milk pumping. This position can be more comfortable for the mother. Lying down and pumping will cause the repositioning of the breast shield on the breast pump. Lying down for pumping will cause the breast cover on the breast pump to be lower than the milk leakage port, and the milk will flow back and will not be pumped as intended. The posture chart for using the breast pump is presented below:



Sitting upright is also a good breast pumping position, which can be selected according to your own situation.



Leaning back and not doing a good job of pumping, which may cause breast milk to leak, so it is not recommended.



Sitting straight and leaning forward is the most ideal breastfeeding position.



Breastfeeding cannot be done using the lying down or side lying position, which should not be used.













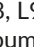

## INSTRUCTIONS FOR USE

1. Sterilize milk-contact parts of the breast pump.
2. Wash your hands, then assemble the sterilized parts by following the ASSEMBLING STEPS.
3. Sit down in the most comfortable position with your upper body leaning forward a little.
4. Gently massage your breast or compress the breast with a warm towel.
5. Put the nipple into the massage cushion pad so that the shield covers the breast tightly.

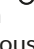
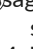

## PUMPING GUIDE

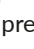
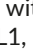
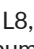
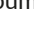
### 1. Massage / Stimulation / Expression mode:

- Touch and hold the  button for 2 seconds to see the LED light turn on. The pump will automatically start the single suction mode  and the level memorized from the previous use. The time LED screen shows "00" and starts counting the working time. Touch the Single/ Double Suction button  to change to the Double suction .
  - Touch the function button  to choose the stimulation mode. It will start with the level memorized from the previous stimulation mode with  symbol. Use buttons  and  to select the suction level at this stage (L1, L2, L3, L4, L5, L6, L7, L8, L9). There are 9 available stimulation levels. Short touch the  button to pause the pump.
  - Touch the function button  to switch to the massage mode. It will start with the level memorized from the previous massage mode with  symbol. Use buttons  and  to select the massage level at this stage (L1, L2, L3, L4, L5, L6, L7, L8, L9). There are 9 available massage levels. Touch the  button to pause the pump.
  - Touch the function button  to switch to the expression mode. It will start with the level memorized from the previous expression mode with  symbol. Use buttons  and  to select the expression level at this stage (L1, L2, L3, L4, L5, L6, L7, L8, L9). There are 9 available expression levels. Touch the  button to pause the pump.
2. The pump is automatically turned off after 30 min of continuous usage.
3. Long touch the  button for 2 second to turn OFF the pump.

## CAUTION

1. Sterilize all parts after disassembling before and after each use.
2. Try to familiarize yourself with the suction control of the breast pump before using it. By placing the funnel against your hand or arm, you can practice using this breast pump.
3. Make sure that all parts are free of cracks or misfits, especially on the valve head fitting with the shield body as this will affect the suction of the breast pump.
4. Contact your health care professional or breastfeeding specialist if you can express minimal to no milk, or if expression is painful.
5. This is not a toy, keep it out of reach of children.
6. DO NOT place the product next to heat sources such as radiators, sunny windows, etc.

## TIPS:

- If your milk does not flow, relax, and reposition the breast shield on your breast, then continue pumping.
- Do not continue pumping for more than 5 minutes if you do not succeed in expressing any milk. Try to pump at another time.
- Consult your lactation advisor or physician if you feel uncomfortable or in pain during pumping.
- It is more effective and better for your breasts when you pump frequently (every 2-3 hours).

# NOSE SUCTION GUIDE

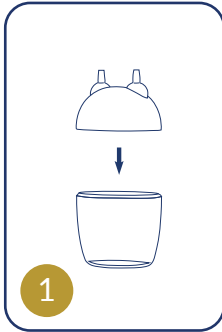

**Step 1** Put the cap with the body of the nose fluid cup (11) together.

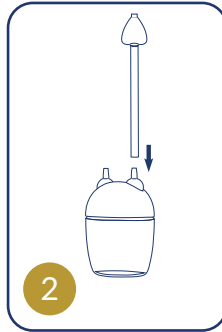

**Step 2** Insert the nose suction tube (10) onto the first hole of the nose fluid cup (11).

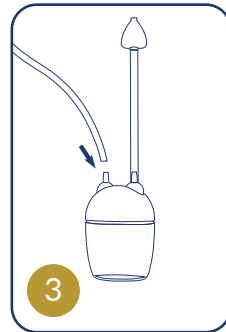

**Step 3** Insert the nose air tube (12) onto the remaining hole of the nose fluid cup (11).

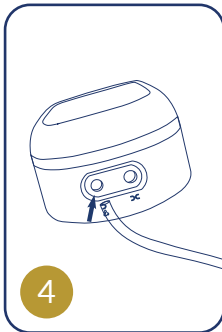

**Step 4** Connect the order end of the nose air tube (12) to the left air hole of the motor (9).

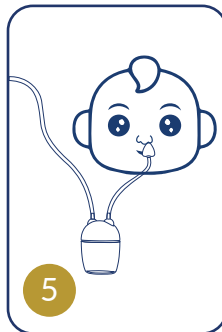

**Step 5** Place the other end of the nose suction tube (10) into your baby's nose, whichever is most comfortable.

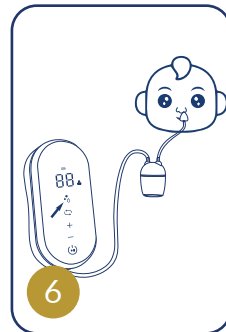

**Step 6** Touch the button, then touch the function button to select the nose suction mode.

## Nose suction function:

1. Make sure nasal aspiration tube, nose air tube and nose fluid cup are sterilized before and after aspirating your baby's nose.
2. Make sure all connections are tightly fit to increase suction efficiency.
3. The left air hole is the default one for nasal aspiration mode, the right air hole cannot be used for that purpose.
4. Touch the Power/Pause button , then touch the function button to select the nasal aspiration mode. Adjust the aspiration level to suit the baby, but still ensure the aspiration effect. Use buttons and to select the aspiration level. There are 9 available nasal suction levels (L1, L2, L3, L4, L5, L6, L7, L8, L9). Touch the button to pause the pump.

## CLEANING THE PUMP

Disassemble all the parts of the breast pump and thoroughly wash them using clean warm soapy water. We recommend sterilizing the product by putting its parts into boiling water for about 2-3 minutes or by using the steam sterilizer/ UV sterilizer/ microwave. Then dry all parts and keep them in a cool and dry place.

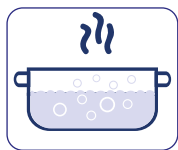

Boiling water



Steam sterilizer



UV Sterilizer



Microwave



Plastic parts may be damaged or deformed if exposed to high temperatures for a long time.

## POWER SUPPLY

Insert the DC connector of the USB line into the USB socket adaptor, insert the adaptor plug in into the power socket.



Only use the original AC adapter. Other adapters may cause damage to the unit.

## LITHIUM-ION BATTERY

This model has a built-in Lithium-ion rechargeable battery, which makes it even easier to transport, as you can simply plug it in to charge when required. The battery must be fully charged before the first use. Do not charge the battery pack for a long time. Charging for 4 hours ensures use for more than 2 hours (You must not remove the inside lithium battery). When the battery symbol flashes, it means the power is low; charge it in time.

### Notes:

- When the motor is operating without the main power supply, the power status will be displayed.
- If the lithium battery is not used for a long time, it will cause the battery to be deeply discharged.
- If the breast pump is out of battery, it needs to be plugged into the power supply for activation. Wait for about 10 min for the screen to light up to continue charging. If the battery is not activated for more than half an hour, consult the InnoGIO customer service.

This product can be charged using a USB charging cable, it can be charged with an adapter/ computer and power bank. Easier to use on the go, more convenient for mums to use.

## HOW TO STORE BREAST MILK

The milk collecting bottle is ready to be given to the baby. If it is not possible to feed the baby immediately, fresh breast milk should be stored in a clean and sealed container labelled with the date of expression. Milk bottles or milk bags can also be used.

**Guidelines for maximum storage time of breast milk.**

	Freezer (~ -18°C)	Refrigerator (~ -4°C)	Ice Pack (~ -15°C)	Room Temperature (22~26°C)
Fresh	3 months	1 day	8 hours	3-4 hours
Unfreeze in Fridge	Do not refreeze	1 day	Do not store	3-4 hours
Unfreeze in warmed water	Do not refreeze	4 hours	Do not store	Feed to baby in short time until feeding ends

### Notes:

- Do not store milk in hot weather.
- Do not use heated water of more than 60°C to thaw the breast milk.
- Do not microwave breast milk.
- Do not add fresh milk to frozen breast milk.

## TROUBLE SHOOTING

	Causes	Check & Solutions
<b>Non-working motor</b>	Power	<ul style="list-style-type: none"> <li>• Check the AC adapter is firmly plugged to main power and the main unit.</li> <li>• Check if the power is turned on.</li> <li>• Contact the InnoGIO Distributor if the pump does not function when the power is turned on.</li> </ul>
	Battery	Check if this symbol flashes, please charge the battery.
<b>Low or no suction</b>	Incorrect assembling	<ul style="list-style-type: none"> <li>• Check that no parts are missing.</li> <li>• Make sure the silicone massager is sealed around the rim of breast shield funnel.</li> <li>• Fit the vacuum set and breast shield tightly.</li> <li>• Check if the silicone ring is properly positioned.</li> <li>• The silicone valve a firmly placed.</li> <li>• Check if the silicone tube is connected to the main unit.</li> <li>• Screw the pump onto the bottle tightly.</li> </ul>
	Damaged parts	Check that any all parts are intact and free of defects such as crack, check frequently for the silicone valve. For spare parts, contact the InnoGIO to obtain the replacement.
	Air escape on the your breast	<ul style="list-style-type: none"> <li>• Press breast shield with silicone massager firmly against your breast.</li> <li>• Reposition breast shield on your breast.</li> </ul>
<b>Discomfort or pain</b>	<ul style="list-style-type: none"> <li>• Adjust the lower suction pressure.</li> <li>• Change the position of the breast shield on your breast.</li> <li>• If pain persists, consult your lactation advisor or physician.</li> </ul>	

This appliance should not be discarded together with the domestic waste at the end of its useful life. It must be disposed of at a central point for recycling of electric and electronic domestic appliances.



# innoGIO

Manufactured in China for **INNOGIO** sp. z o.o.  
Ostródzka street 74H, 03-289 Warsaw, Poland  
**www.innogio.com**

 @innoGIO.official

 @innogio\_com